

HardieTex™ system



What is it?

A strong, pre-primed base sheet that is finished on-site with a specialised texture coat system,* which includes joint reinforcement. HardieTex system is the original way to create a decorative, monolithic rendered look without the need for masonry.

Where do you use it?

As an external cladding in residential homes, including alterations and additions, where a lightweight system with a monolithic rendered look is required. Ideal for full wrap or composite construction designs on either timber or light gauge steel framed homes.

What are the key benefits?

AFFORDABILITY. When it comes to double storeys in particular, two big cost-drivers are scaffolding and structural beams. Using pre-primed, lightweight HardieTex base sheet instead of rendered masonry can help significantly reduce those costs.

DESIGN FLEXIBILITY. The seamless, monolithic look created with HardieTex system makes it a perfect foil for a special design accent. A variety of textures and colours can be achieved with a site-applied texture system, making HardieTex base sheet the perfect canvas for a diverse mix of colours and textures.

VERSATILITY. HardieTex base sheet can also be used as bracing.**

SECURITY. Manufactured by James Hardie for more than 20 years, HardieTex base sheet is the 'original' fibre cement cladding designed for the application of a third party specialised 2mm thick acrylic texture coating. HardieTex base sheet is resistant to damage from termites, rot and fire†.

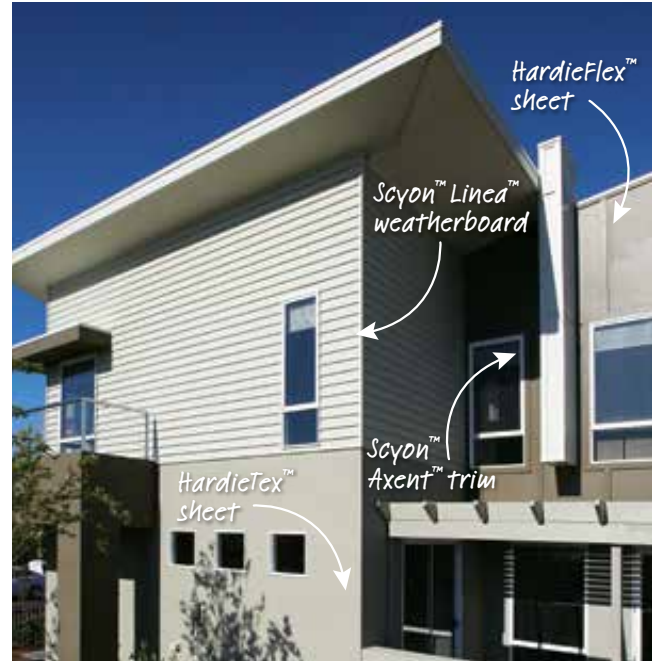

Closeup detail

What are the sizes?

Product code	Length (mm)	Width (mm)	Thickness (mm)	Mass (kg/m ²)
400293	2,440	900	7.5	11.33
401651	2,440	1,200	7.5	11.33
400295	2,725	900	7.5	11.33
400294	2,725	1,200	7.5	11.33
400296	3,000	900	7.5	11.33
400291	3,000	1,200	7.5	11.33

Selling units per pack: 30 sheets or each

What are the accessories?

Accessory	Code	Page
HardieBlade™ Saw Blade 185mm	300660	51
HardieBlade™ Saw Blade 254mm	303375	51
HardieDrive™ Screws 32mm long	305532	51
HardieDrive™ Screws 40mm long	305533	51
HardieTex™ 7.5mm PVC Z Flashing	305569	52
James Hardie™ Fibreshears	300653	53
James Hardie™ Joint Sealant^ 300ml cartridge	305534	54
James Hardie™ Joint Sealant^ 600ml sausage	305672	54
James Hardie™ 7.5mm PVC Starter Strip	305568	55
James Hardie™ Score and Snap Knife	305576	55

Single timber stud

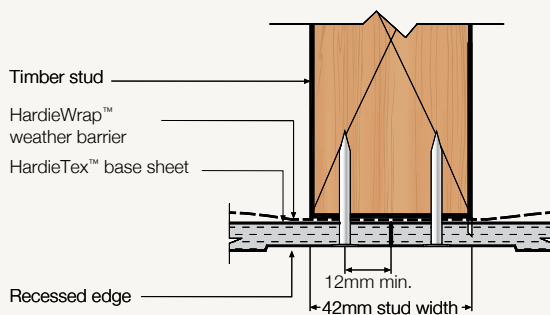

Note All dimensions and masses provided are approximate only and subject to manufacturing tolerances. Masses are based on equilibrium moisture content of product.

* To be applied in accordance with the texture coat manufacturer's guidelines. ** When installed in accordance with James Hardie's Structural Bracing Application Guide.

† When installed and maintained correctly and to the extent set out in James Hardie's published literature current at the time of installation. ^ Not to be used in fire applications.